

John Mendinghall & Company Land.

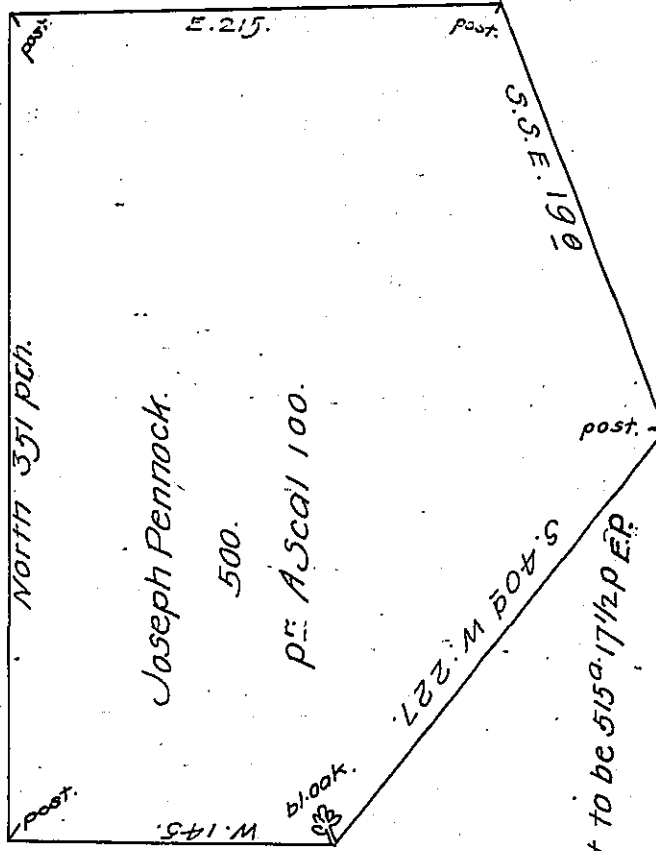

To Edward Pennington Surv^r Gen^l

By vertu of a warrant to me directed bearing date the 25th m^o 17⁽⁶¹⁾ I have surveyed unto Joseph pennock A tract of Land situate on the South side of Brandywin Creek beginning at post being a corner post of John Mendinghall and Company Land thence by a line Est 215 pch. to a bounded post then S. S. E. 190 pch. to a bounded post then south 40^d west 227 pch. to a bounded black oak thence west 145 pch. to a bounded post being a post of the aforesd Land then by their line north 351 pch. to the place of begining Laid out for 500 Acres of Land the 25th day of 10^{br} 1700 p^r

Henry Hollingsworth, Dpt. Surv^r

IN TESTIMONY that the above is a copy of the original remaining on file in the Department of Internal Affairs of Pennsylvania, made conformably to an Act of Assembly approved the 16th day of February, 1833, I have hereunto set my Hand and caused the Seal of said Department to be affixed at Harrisburg, this second day of October, 1909.

Henry House
 Secretary of Internal Affairs.